

EasyLogic APF 7-inch HMI Firmware Upgrade Instruction

- Follow the instruction below if current firmware version is 322

HMI Interface Upgrade

Upgrade Media Requirement

1. SD card and SD card reader



2. SD card capacity should be 2G - 8G, and file system of SD card must be "FAT32 format" with "4096 bytes"

Format USB Drive (D:) X

Capacity:
7.40 GB

File system
FAT32 (Default)

Allocation unit size
4096 bytes

Restore device defaults

Volume label

Format options
☒ Quick Format

Start Close

Upgrade Process

1. Power Off EasyLogic APF

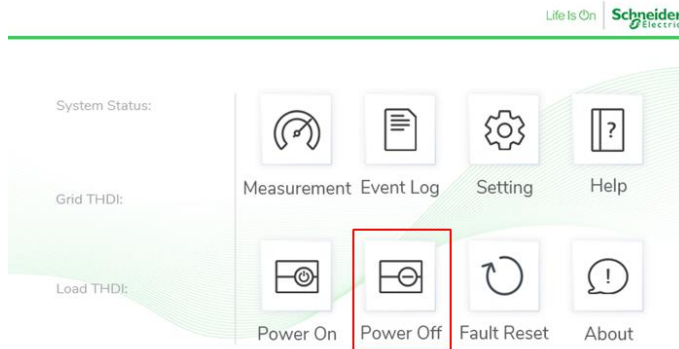

2. Copy **DWIN_SET** folder to SD card.

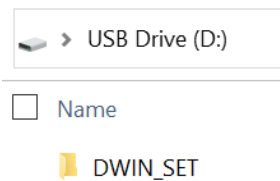

3. Insert SD card into the slot on the left side of HMI (as shown below). You will hear a “click” sound once SD card is successfully inserted.



4. After SD card is inserted, blue screen will appear for a while, followed by all the latest HMI interfaces flashing one by one. It will take 1-2 mins to complete this process.
5. Once completed, you will see the startup interface (as shown below)

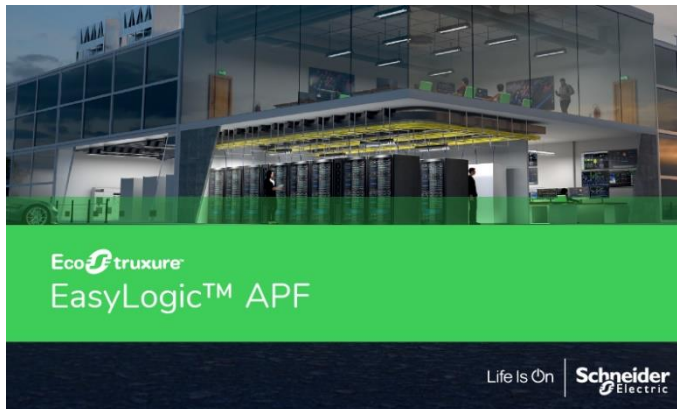

6. Remove SD card and restart HMI (switch off and on APF power) to complete the upgrade.

HMI Communication Upgrade

Upgrade Media Requirement

1. USD Disk



Upgrade Process

1. **Power Off** EasyLogic APF

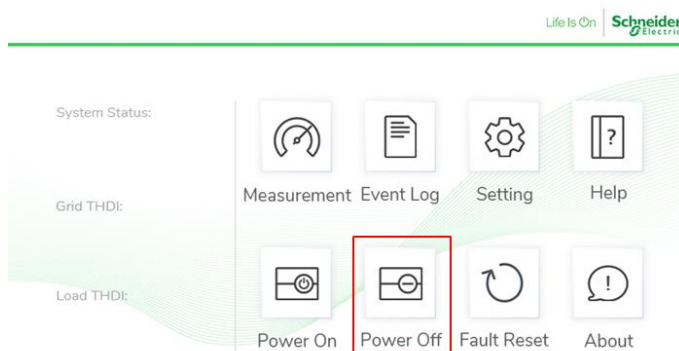

2. Copy **monitor.tar.gz** file to USB Disk.

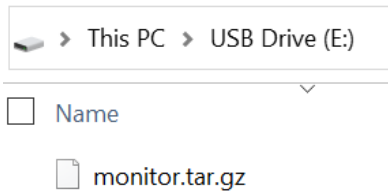

3. Insert USB Disk into the slot on the left side of HMI (as shown below).



4. Select **Setting** and key in password (08080808) to proceed.

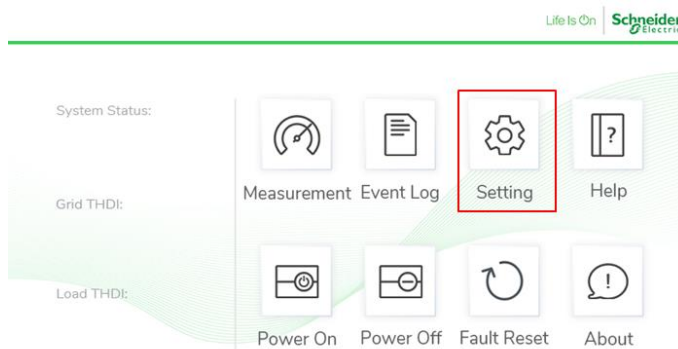

5. Select **Customize** and then click **Upgrade**.

< ⚙️ Setting Life Is On Schneider Electric

SYSTEM COMMUNICATION HARMONICS **CUSTOMIZE** DEBUG

Date sync Language

Monitor Admin Password

SVGD Module set Security Questions

Comm. Enable set

Backlight Brightness (10-64) set Power Saving

Lighting Time (10s-255s) set

You will hear a few “beep” sound once upgrade is started. Then HMI will be restarted and upgrade is completed with a few “beep” sound.

You can click **About** to check the **Software version** before and after upgrade.

Life Is On Schneider Electric

System Status:

Grid THDI:

Load THDI:

Measurement Event Log Setting Help

Power On Power Off Fault Reset **About**

< ⓘ About Life Is On Schneider Electric

Machine code ID 00000

Software version **MG322D000B000**

System model ID 380-0/0-0-0-0

- Follow the instruction below if current firmware version is 324

HMI Interface Upgrade

Upgrade Media Requirement

3. SD card and SD card reader



4. SD card capacity should be 2G - 8G, and file system of SD card must be "FAT32 format" with "4096 bytes"

Format USB Drive (D:) X

Capacity:
7.40 GB

File system
FAT32 (Default)

Allocation unit size
4096 bytes

Restore device defaults

Volume label

Format options
☒ Quick Format

Start Close

Upgrade Process

7. **Power Off** EasyLogic APF



8. Copy **DWIN_SET** folder to SD card.

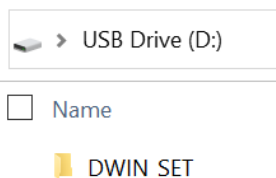

9. Insert SD card into the slot on the left side of HMI (as shown below). You will hear a “click” sound once SD card is successfully inserted.



10. After SD card is inserted, blue screen will appear for a while, followed by all the latest HMI interfaces flashing one by one. It will take 1-2 mins to complete this process.
11. Once completed, you will see the startup interface (as shown below)

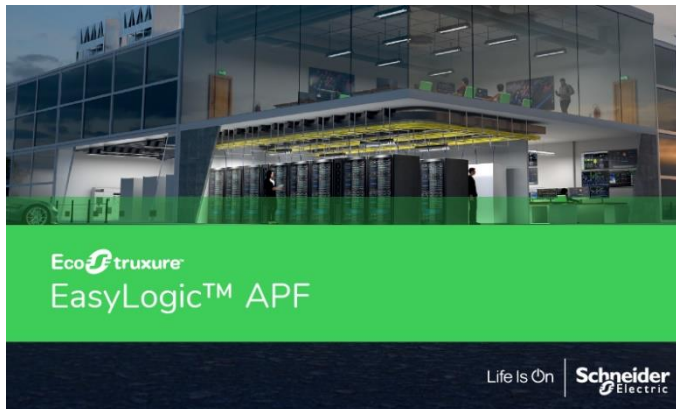

12. Remove SD card and restart HMI (switch off and on APF power) to complete the upgrade.

HMI Communication Upgrade

Upgrade Media Requirement

2. USB Disk



Upgrade Process

6. Power Off EasyLogic APF



7. Copy **monitor.tar.gz** file to USB Disk.

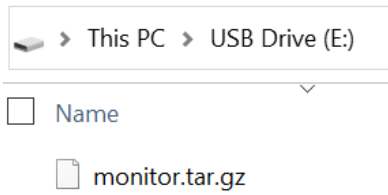

8. Insert USB Disk into the slot on the left side of HMI (as shown below).



9. Select **Setting** and key in password (08080808) to proceed.

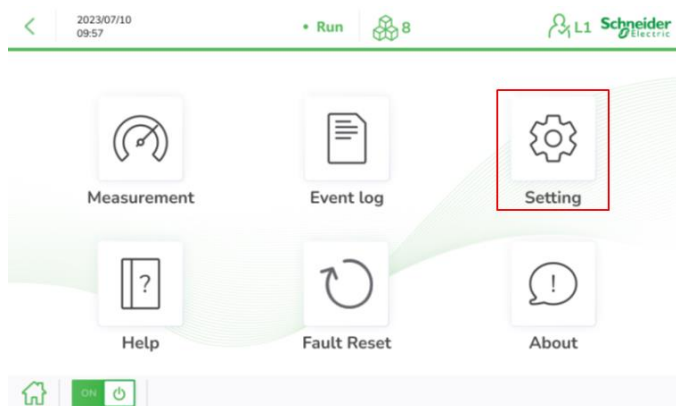

10. Select **Customize** and then click **Upgrade**.

< Setting 2023/07/10 09:57 • Running 8 L1 Schneider Electric

Date: 2023-07-10 09:57:00 Sync

Language: English

Monitor: Jianye

Backlight Brightness (10-64): 60 Set

Lighting Time (10s-255s): 120 Set

Power Saving

Security Questions

Change Operator Password

System Compensation Communication Customize

Report Upgrade Factory Reset

You will hear a few “beep” sound once upgrade is started. Then HMI will be restarted and upgrade is completed with a few “beep” sound.

You can click **About** to check the **Software version** before and after upgrade.

< About 2023/07/10 09:57 • Running 8 L1 Schneider Electric

Measurement Event log Setting

Help Fault Reset About

Software Version MG324D025B000C005

System Model ID 380-150/150-3-0-1-0

Select: M. 1